

User Manual



Multi Wavelength Therapy User Guider

Create a better life with LED technology



Content

About Red Light Therapy.....	2-3
Product Structure & Model Specificaiton.....	4-8
Parts Include.....	9
Operating Instructions.....	10-11
Instruction of installation.....	12-13
Frequent Questions.....	14
Storing & Safety Information.....	15

Red light Therapy Family!

We are excited to have you join us, and we can't wait to see how you benefit from the power of Red & Near Infrared Light Therapy. It delivers irradiance at both Red nm (visible red light), NIR nm (Invisiblennear infrared light), or a combination of both. These light wavelengths have been scientifically proven to provide therapeutic effects.

What is Red light Therapy?

Red light therapy (RLT) is a controversial therapeutic technique that uses red low-level wavelengths of light to therapy skin issues, such as wrinkles, scars, and persistent wounds.

How does red light therapy work?

Red light is thought to work by producing a biochemical effect in cells that strengthens the mitochondria. The mitochondria are the powerhouse of the cell — it's where the cell's energy is created. The energy-carrying molecule found in the cells of all living things is called ATP (adenosine triphosphate).

By increasing the function of the mitochondria using RLT, a cell can make more ATP. With more energy, cells can function more efficiently, rejuvenate themselves, and repair damage. RLT is different from laser or intense pulsed light (IPL) therapies because it doesn't cause damage to the skin surface. Laser and pulsed light therapies work by causing controlled damage to the outer layer of the skin, which then induces tissue repair. RLT bypasses this harsh step by directly stimulating regeneration of the skin. The light emitted by RLT penetrates roughly 5 millimeters below the skin's surface.

VISIBLE LIGHT SPECTRUM CHART
NATURAL VISIBLE LIGHT SPECTRUM IN NANOMETERS

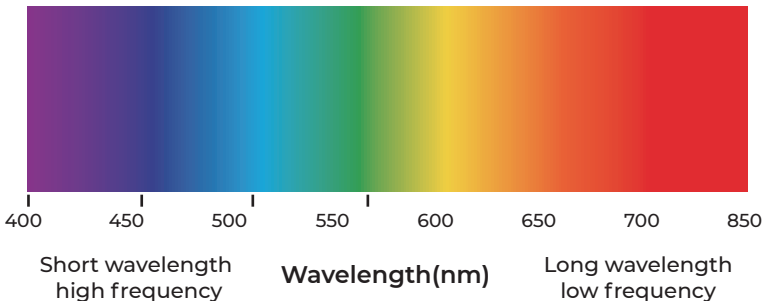

Benefits Of Red Light Therapy

What are the health benefits of light therapy? We'll cover some of the main ones below.

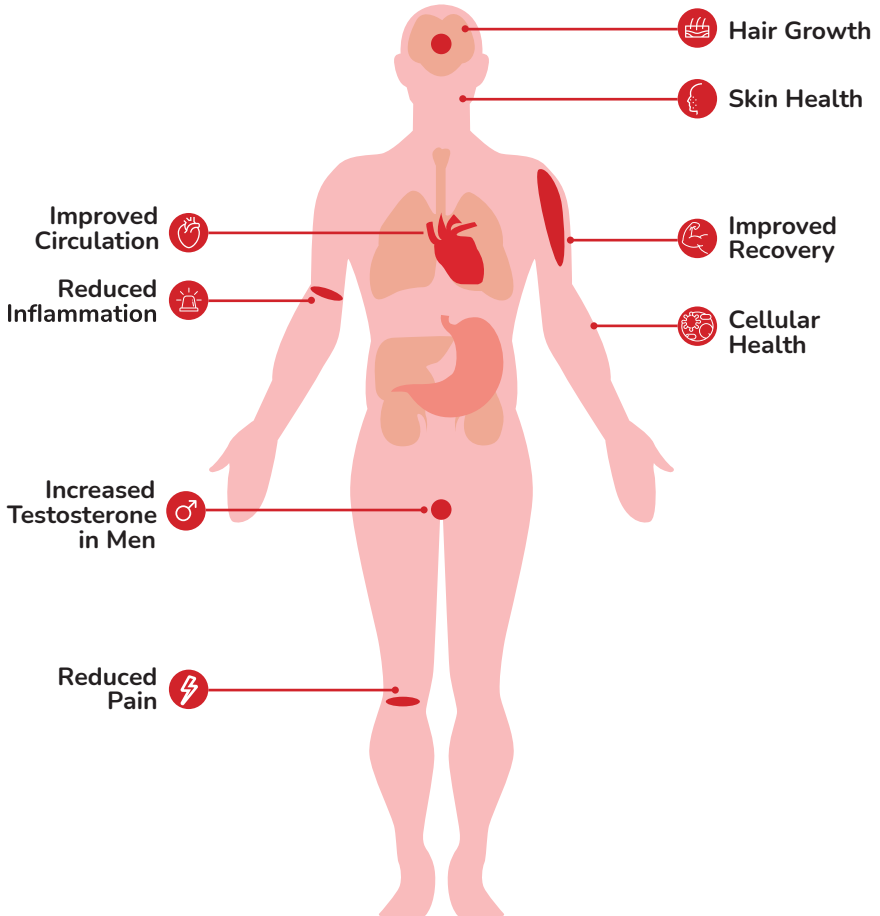

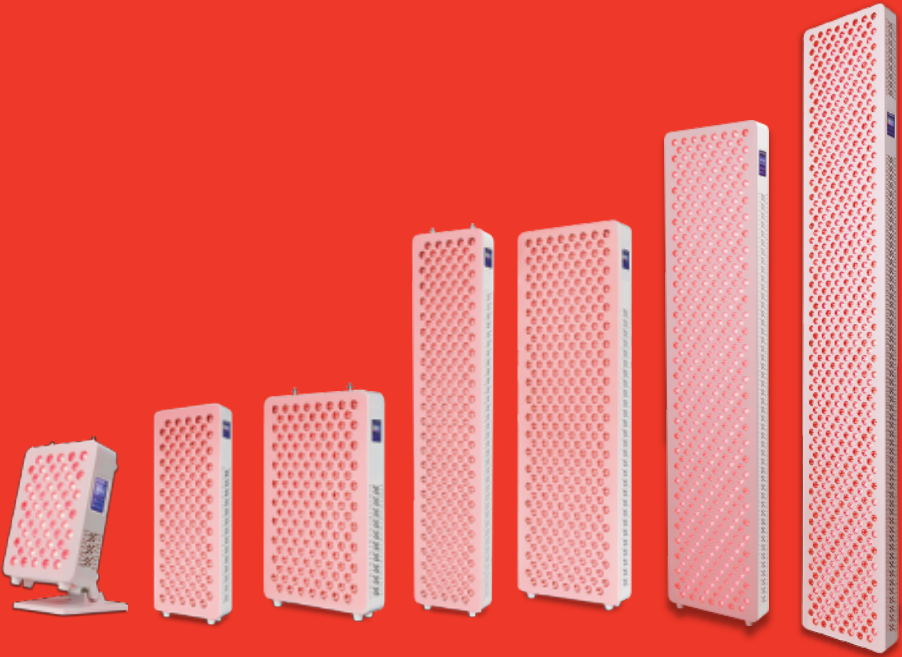

Mini

Mid

Pro

Max

Mega

Elite

Ultimate

Product Structure



Noted. This is the product description for one model, other modes have different size and led chip quantity.

Mini

Dimensions	11.2"*8.2"*2.5"
LED Count	60Pcs 3W/5W
Lens Beam Angle	30 Degree
Input Voltage	10-240V 50/60Hz
Irradiance	>219mw/cm ² at the surface of the Leds >160 mw/cm ² @6inches distance
Wavelength	630/660/810/830/850nm (Option 2 with 480nm/1060nm)
Weight	2.4kg
Warranty	2 years
Best Userd for	Target treatment
Certifications	CE,FDA, ROHS



Mid

Dimensions	21.2"*8.2"*2.5"
LED Count	120Pcs 3W/5W
Lens Beam Angle	30 Degree
Input Voltage	10-240V 50/60Hz
Irradiance	>219mw/cm ² at the surface of the Leds >160 mw/cm ² @6inches distance
Wavelength	630/660/810/830/850nm (Option 2 with 480nm/1060nm)
Weight	4kg
Warranty	2 years
Best Userd for	Half body or whole body treatment
Certifications	CE,FDA, ROHS

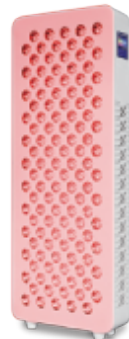

Pro

Dimensions	18.8"*11.8"*2.5"
LED Count	150Pcs 3W/5W
Lens Beam Angle	30 Degree
Input Voltage	10-240V 50/60Hz
Irradiance	>219mw/cm ² at the surface of the Leds >160 mw/cm ² @6inches distance
Wavelength	630/660/810/830/850nm (Option 2 with 480nm/1060nm)
Weight	5.7kg
Warranty	2 years
Best Userd for	Half body or whole body treatment
Certifications	CE,FDA, ROHS

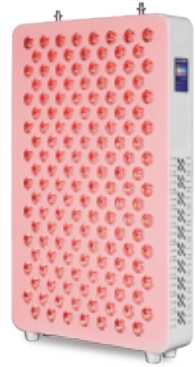

Max

Dimensions	39.3"*8.2"*2.5"
LED Count	240Pcs 3W/5W
Lens Beam Angle	30 Degree
Input Voltage	10-240V 50/60Hz
Irradiance	>219mw/cm ² at the surface of the Leds >160 mw/cm ² @6inches distance
Wavelength	630/660/810/830/850nm (Option 2 with 480nm/1060nm)
Weight	7.2kg
Warranty	2 years
Best Userd for	Half body or whole body treatment
Certifications	CE,FDA, ROHS



Mega

Dimensions	36.2"*11.8"*2.5"
LED Count	300Pcs 3W/5W
Lens Beam Angle	30 Degree
Input Voltage	10-240V 50/60Hz
Irradiance	>219mw/cm ² at the surface of the Leds >160 mw/cm ² @6inches distance
Wavelength	630/660/810/830/850nm (Option 2 with 480nm/1060nm)
Weight	10.5kg
Warranty	2 years
Best Userd for	Half body or whole body treatment
Certifications	CE,FDA, ROHS

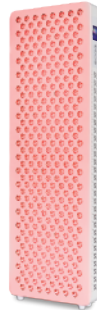

Elite

Dimensions	53.5"*11.8"*2.5"
LED Count	450Pcs 3W/5W
Lens Beam Angle	30 Degree
Input Voltage	10-240V 50/60Hz
Irradiance	>219mw/cm ² at the surface of the Leds >160 mw/cm ² @6inches distance
Wavelength	630/660/810/830/850nm (Option 2 with 480nm/1060nm)
Weight	15.4kg
Warranty	2 years
Best Userd for	Whole body treatment
Certifications	CE,FDA, ROHS

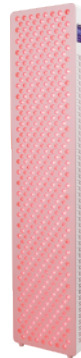

Ultimate

Dimensions	71.7"*11.8"*2.5"
LED Count	600Pcs 3W/5W
Lens Beam Angle	30 Degree
Input Voltage	10-240V 50/60Hz
Irradiance	>219mw/cm ² at the surface of the Leds >160 mw/cm ² @6inches distance
Wavelength	630/660/810/830/850nm (Option 2 with 480nm/1060nm)
Weight	18.9kg
Warranty	2 years
Best Userd for	Whole body treatment
Certifications	CE,FDA, ROHS



Parts Include

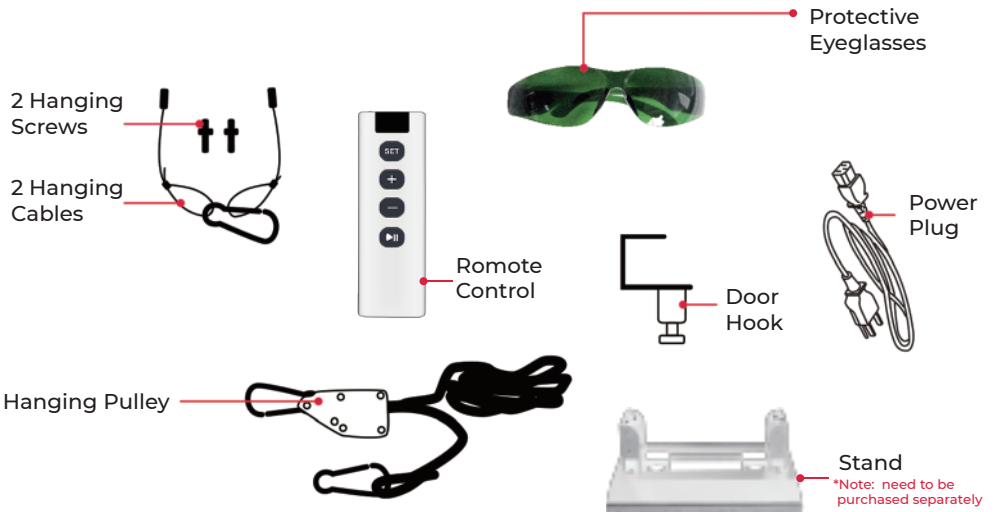

Mini

1x Light

1x Power Plug

1x Manual

1x Glasses

1x Remote Control

Mid, Pro, Max, Mega, Elite, Ultimate

1x Light

1x Power Plug

1x Manual

1x Glasses

1x Remote Control

2 x Hanging Screws

1x Door Hook

1x Hanging Pulley

2 x Hanging Cables

Operating Instructions

1. Master interface

- ▶ 1) Here is the detailed result to show what you have settled for the Timer, Mode, Dimmable, Frequency
- ▶ 2) Start/Pause: Press it to turn on or turn off
- ▶ 3) Setting: Enter this button so you can enter into sub-interface



2. Slave interface

- ▶ 1) Timer: It supports 0-30Mins. Two ways for time setting,
 - ◀ Drag the bar on the circle to adjust time
 - ◀ Click the center of circle area, so you will get the following page, and enter your desired time number. then press tick mark to save.



- ▶ 2) Mode: There are 3 modes, R, NIR, R+NIR

R: It means red light, such as 630nm 660nm

NIR: It means infrared light, such as 810nm 830nm 850nm, pls notice that the NIR is invisible to our naked eyes.



- ▶ 3) Dimmable: It supports 0-100% brightness. Two ways for brightness setting,

- ◀Click the left "+" or "-" to adjust the brightness
- ◀Slide to the right icon to quickly adjust brightness



- ▶ 4) Frequency: It supports 0-10000Hz. Two ways for frequency setting,

- ◀Click the "+" or "-" to adjust the frequency
- ◀Click the Null, so you will get the following interface, and enter your desired frequency number.



- ▶ 5) Blue light option provide 480nm as an extra function base on regular programme. Enter set, and drag the slide to the bottom, you will see the "Blue Light", "on/off" to turn on or off independently.



Instruction of installation

STEP 1

- Turn the face of your towards the scratch-free surface.
- Next, screw in the threaded posts on the top of the device.
- Then, screw the braided cables to the threaded posts.

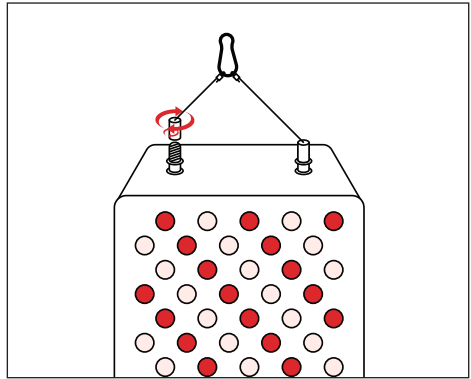

STEP 2

- Hang your device with the help of a hook on any standard sized door.

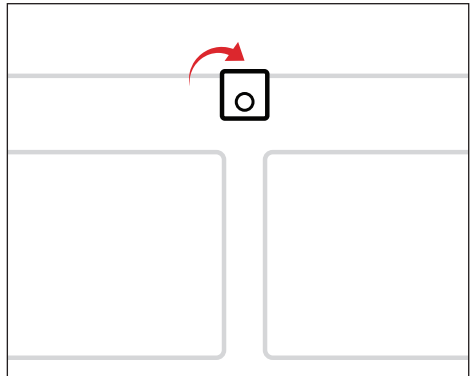

STEP 3

- Hang your red light on a door by connecting the braided cables to the snap link, make sure pulley at the bottom connect with lamp and the other side to door hook.

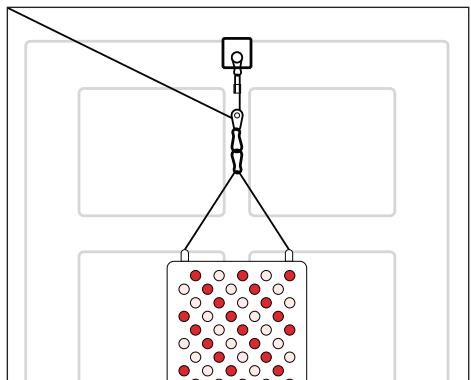

STEP 4

- For raising the height of your red light, support the device with your opposite hand and pull up the loose cable.

Be sure to adequately support the device while raising and lowering it with the height-adjusting system.

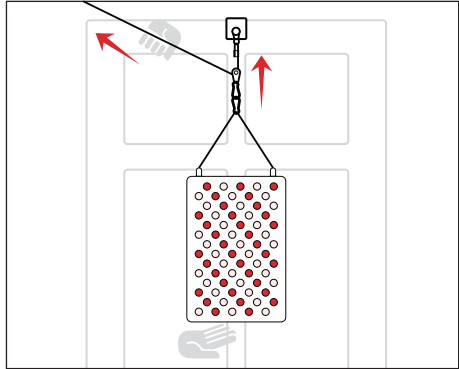

STEP 5

- Push down on the lever on the height adjusting pulley to lower your red light and support the device with your opposite hand.

Be sure to adequately support the device while raising and lowering it with the height-adjusting system.

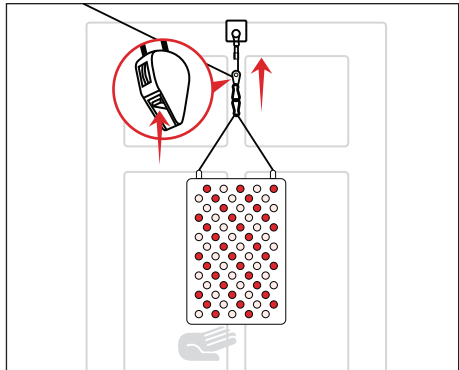

STEP 6

- There is a male power socket on the backside of the device, insert the power cord into it.
- Turn the power switch on.

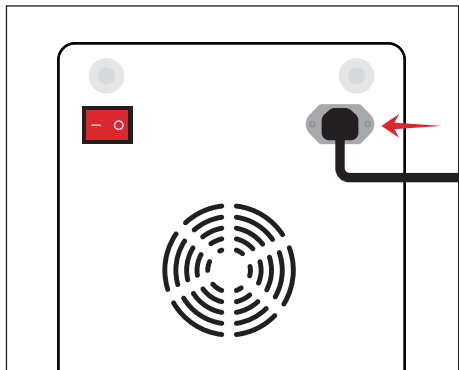

Frequent Questions

How should I use my red light?

For maximizing cellular health, including deep tissue treatment, it is recommended to use your red light every day or at least five times a week. For getting pain relief from strains and aches, three treatments per day are suggested.

Should I wear eye protection?

Eyewear is not required; it's optional. Your eyes are not accustomed to the red light, and red light may appear very bright. For this reason, we recommend closing your eyes or wear sunglasses. If you have any concerns, consult your trusted healthcare provider.

Why do the near-infrared LEDs on my RTL look like they are not working?

The human eye can only see wavelengths of light up to 760nm on average. red therapy uses a wavelength of 810nm&830nm&850nm for the near-infrared LEDs, that a naked human eye cannot observe.

What is the difference between red and near-infrared wavelengths?

Both near-infrared light at 810nm&830nm&850nm and red light at 630nm&660nm have been designed to improve cellular function. The main difference is that the skin tissues absorb the red light, leading to enhance collagen production and skin health. Near-infrared light at 850 nm is not visible to the human eye. It penetrates deeper tissue, leading to benefits like increased reduced joint pain and muscle recovery.

Can I wear clothes when using the red light ?

Yes, you can wear clothes, or you can be nude during the treatment. The only thing that does matter is the specific area of the body you want to be treated is fully exposed to the body. That area should not be covered by any clothing.

Will the red light interface with the medications I use?

Many clinical studies and researches have proven that light therapy is effective and safe. However, if you are using medications such as Retin A, Digoxin, Tetracycline, or other photosensitizing drugs, we recommend you to consult your healthcare provider or therapist before using the red light.

Is it safe for children to use the red light?

Clinical studies have shown light therapy to be safe and have no side effects. But, before using red light to children, contact your doctor.

Care And Cleaning

Before cleaning your device(s), make sure the device(s) are powered off and power cords are unplugged from any power source. Please remove devices from their mounting accessories before cleaning. To clean your panel, except lens parts, you can use a microfiber rag with water to clean the body of the device. Do not spray or apply any moisture to the device directly. Be careful when wiping around vented slot openings, LED openings, and any input or output openings to avoid moisture intrusion.

***Caution: Do not use chemical cleaning agents such as alcohol to clean the surface of lens of the device.**

Storing the Device(s)

The device and accessories should be stored in a clean and dry location. Storage Condition:

*** Temperature 0°C ~ 40°C (32°F -104°F)**

*** Humidity less than 50% Warranty devices do not require any user maintenance. If the device requires servicing, please contact at**

Devices and parts are covered by a 2-year limited warranty.

WARNINGS

1. The appliance is not to be used by persons (including children) with reduced physical, sensory or mental capabilities, or lack of experience and knowledge, unless they have been given supervision or instruction.
2. Children being supervised not to play with the appliance.
3. WARNING: Do not stare at the emitter. Read instructions carefully.
4. Please protection of the eyes against exposure to visible and infrared radiation;strictly follow the cycle time specified in the usage instructions
5. If unexpected side effects, such as itching, occur within 48 h of the first session of using an appliance, medical advice should be sought prior to further exposure;
6. The appliance must not be used if the timer is faulty or the filter is broken or removed.
7. Forbid replacement by the user and tools are needed to replace the emitters.



Our products are not intended to diagnose, treat, cure, or prevent any disease. Our products are low-risk, general wellness / fitness products in accordance with the "General Wellness: Policy on Low Risk Devices" draft released January 20, 2015.